

IELTS Listening Practice Test 56
SECTION 3

Questions 21-26

Write the correct letter, A-F, next to questions 21-26.

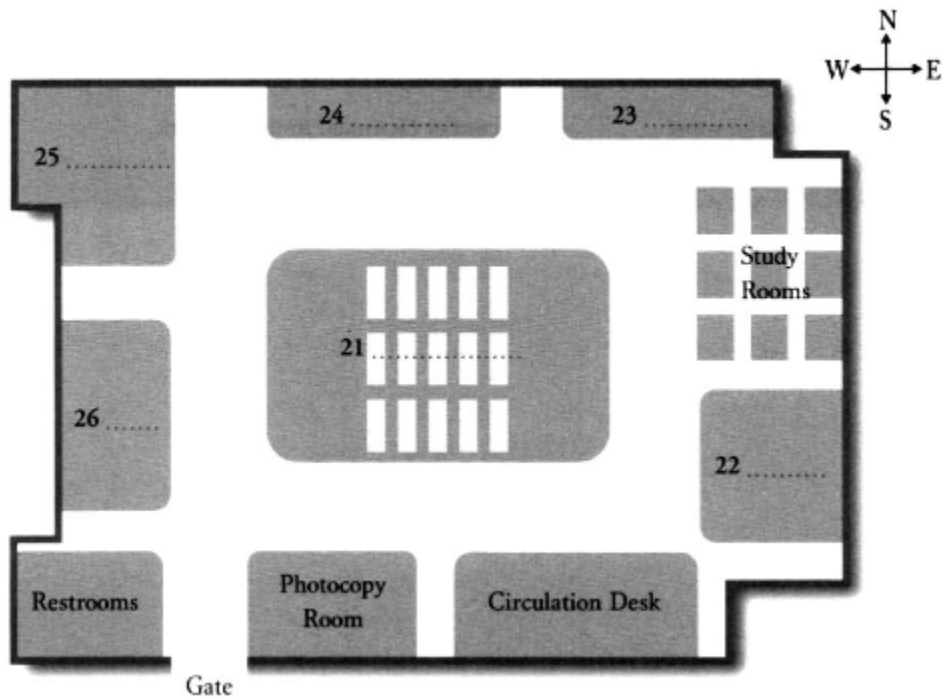

- A Video Resource Centre
- B Reading Room
- C Food Service Centre
- D Periodicals Section
- E Enquiry Desk
- F Satellite TV Station

- 21
- 22
- 23
- 24
- 25
- 26

Questions 27-30

Complete the sentences below.

Write NO MORE THAN THREE WORDS for each answer.

If you need to find information on a certain book, you can use 27..... check-out cards.

If you want to find information in a specific field, use the 28..... guides.

Computers in some 29..... cannot be linked to the network.

You can find more information in a 30..... on my desk.